

PRICELIST & SPECIFICATION



LOA		12.40 m	40' 8"
Hull length		11.99 m	39' 4"
LWL		11.40 m	37' 5"
Beam		4.17 m	13' 8"
Draft			
shallow keel		1.74 m	5' 9"
L-keel, medium		2.07 m	6' 9"

Displacement			
shallow keel	approx.	10.41 t	22,950 lbs
L-keel, medium	approx.	10.15 t	22,377 lbs

Engine Diesel			
standard	approx.	39.00 PS	39.00 hp
option	approx.	57.00 PS	57.00 hp

Fuel tank	approx.	160 l	42 gal
Fresh water	approx.	475 l	125 gal

CE Certificate	A - 10
Design	judel / vrolijk & co
Interior	HanseYachts Design

Mast length above WL	approx.	19.60 m	64' 4"
Total sail area	approx.	86.80 m²	934 sq ft
Main sail			
standard	approx.	52.20 m²	562 sq ft
furling	approx.	47.70 m²	513 sq ft
Self-tacking jib	approx.	34.60 m²	372 sq ft
Crossover	approx.	86.00 m²	926 sq ft
Gennaker	approx.	134.70 m²	1,450 sq ft

418

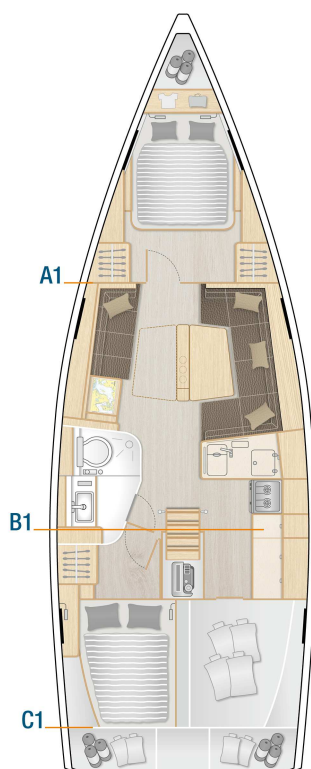

Standard

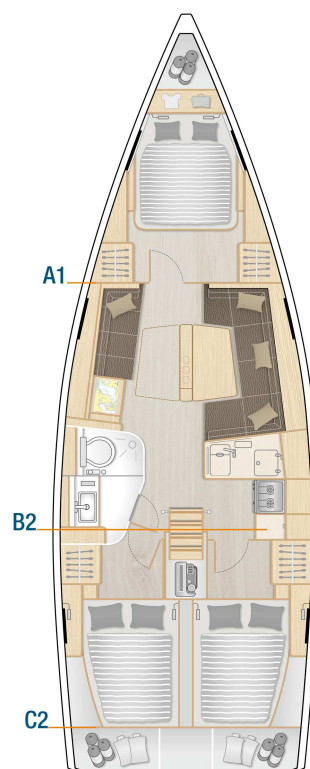

Option

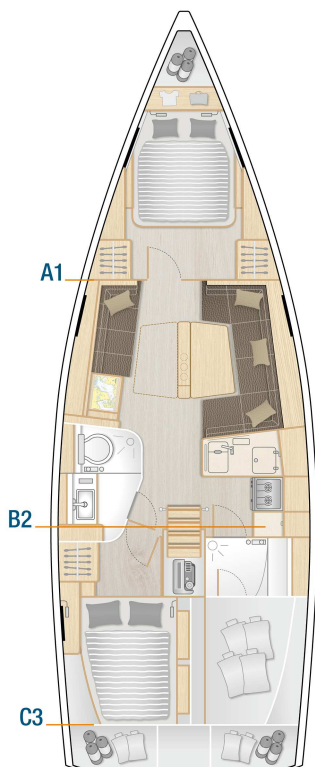

Option

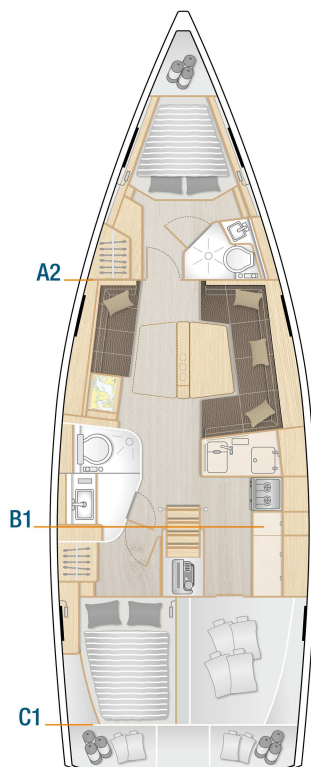

Option

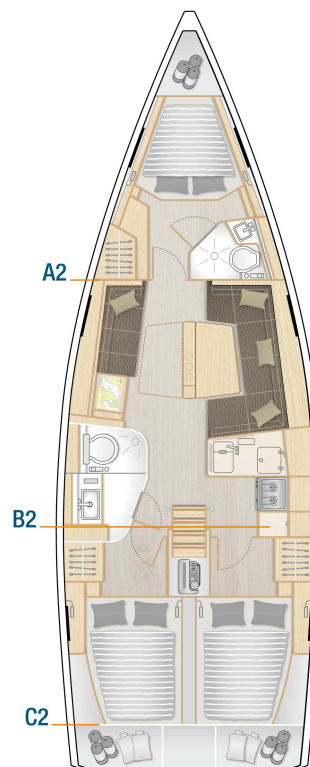

Option

HULL

- 6 hull windows (3 each side)
- GRP hull, isophthalic gelcoat, colour: Signal White (similar RAL 9003), 1st layer vinyl ester resin and balsa sandwich laminat
- Waterline and cove line, isophthalic gelcoat, colour: Dark Grey (similar RAL 7043)

KEEL

- L-keel, cast iron, draft: 2.07 m
- GRP rudder with sea-water resistant aluminium shaft and selfaligning bearings

LAYOUT & INTERIOR

- A1: Master cabin with island double berth and storage space
- B1: Saloon with large L-galley, dining area on stb and sofa on port
 - separate head with shower stall on port (only with layout C1)
- C1: Aft cabin with double berth and storage space on port, utility room on stb (only with layout B1)
- 2-burner gas stove, 12 V fridge approx. 130 l, waste bin, double stainless steel sink with mixing tab
- Interior furniture in high quality marine plywood, satin varnish
- Hanse companionway closing system
- Saloon table, folding with stowage
- Worktop in galley - Black Quartz

WOOD (FURNITURE, FLOORBOARD)

- Furniture - Mahogany Style, Satin Varnish
- Cupboard fronts in wood colour
- Floorboard - Acacia

UPHOLSTERY

- Mattresses for all berths
- Upholstery - Monte Carlo, colour: Cream

DECK & OUTSIDE EQUIPMENT

- GRP deck with antislip surface, isophthalic gelcoat, colour: Signal White (similar RAL 9003), 1st layer vinyl ester resin with balsa sandwich core. 1 cockpit locker on stb, stern locker on port and stb, stowage for running rigging at helm position, anchor locker at bow.
- Synthetic teak on cockpit benches (colour selection)

- Synthetic teak on bathing platform (colour selection)
- Twin wheel steering system with emergency tiller
- 2 stainless steel steering wheels with leather cover
- Cockpit table, stainless steel with folding teak tops
- Pulpit and pushpit, stainless steel
- Railing, incl. stanchions and stainless steel wire
- Covered halyards and control lines lead to cockpit helm position, organizers and jammers, 4 mooring cleats, handrail on coach roof, bow anchor fitting with step
- 2 LEWMAR 45 ST EVO manual halyard winches
- Bathing platform, manual fold-out with swimming ladder
- Anchor and forestay fitting
- Self tacking jib system
- Mainsheet system
- 5 deck hatches - openable, anchor locker hatch, stowage on coach roof with acrylic glass hatch
- Coach roof side windows with openable portlight on ps
- 6 deck coach roof windows with openable portlight in bathroom, glass next to companionway, glass in saloon and master cabin, 2 portlights in cockpit side for aft-cabins

RIG & SAILS

- Rig, anodized aluminium, deck stepped, with kicker, standing and running rigging and 2 reefs
- Manual jib furler
- QUANTUM Dacron sails - full battened, main and jib

NAVIGATION & INSTRUMENTS

- Illuminated compass
- Navigation lights - LED

PROPULSION

- Fuel tank, approx. 160 l
- Engine (Diesel, approx. 39 hp) - saildrive, 2-blade fix propeller

EQUIPMENT

- 12 V and 230 V electric system with main panels and 230 V shore power and sockets.
- AGM battery set, capacity: 1x 90 Ah + 1x 160 Ah AGM
- Country Version: EU / AUS
- Battery charger

- Manual toilet with sea water flush - cabin layout B
- LPG gas system, stowage for 1 gas bottle
- Black water system (appr. 55 l) with deck extraction and seacock for head, electric and manual bilge pump
- Fresh water system with electric pump and 20 l hotwater, heated also by main engine
- Fresh water tank, appr. 295 l
- Add. fresh water tank, appr. 180 l

SHIPPING & TRANSPORT

- CE - Certificate cat. A - 10 / B - 12 / C - 14
- Owners manual
- EC - Type Examination Certificate

AS PER STANDARD SPECIFICATION

excl. VAT
215.900 €

PACKAGES

XW2000 B&G Navigation Package 11.590 €

XF2200	2 B&G Triton ² multifunction displays in cockpit, incl. transducer (wind/depth/speed/temperature)
XF3000	B&G VHF V60 at chart table, incl. wireless remote handset H60 (only with XK5000)
XF4010	B&G Zeus ³ S 9" chart plotter at cockpit table
XF5000	B&G Autopilot with Triton ² control unit with WR10 remote control and Precision 9 compass
XK5000	VHF preparation with antenna and splitter for FM and AIS

XW2001 Upgrade - 12" chart plotter 1.290 €

XF4011	B&G Zeus ³ S 12" chart plotter at cockpit table
--------	--

XW3000 Cruising Package 8.590 €

XC1326	Synthetic teak on cockpit bottom (colour selection)
XC1334	Synthetic teak on helmsman seats (colour selection)
XC9060	2 helmsman seats, foldable
XC9062	Helmsman footrests (free mountable)
XC9080	2 additional cleats, midship (1 each side)
XC9090	Anchor windlass, electrical, with automatic fuse and remote control with chain counter
XC9100	Delta-anchor 16 kg, galvanized with 30 m galvanized chain
XC9422	Coach roof side windows with openable portlight on stb
XH1001	Battery set, capacity: 1x 90 Ah + 2x 160 Ah AGM
XH3110	Shower unit in cockpit, warm-/coldwater
XH5030	Water akku for pressure equalization
XV9420	Wind indicator
XV9450	Flagpole
XV9901	6 fenders
XV9902	4 mooring lines
XV9910	Add. winch handle
XV9920	Mast steps
XV9950	HANSE maintenance kit

XW3001	Upgrade - Real teak	690 €
XC1325	Real teak on cockpit bottom	
XC1333	Real teak on helmsman seats	
XC1340	Real teak on cockpit benches	
XC1350	Real teak on bathing platform	
<hr/>		
XW3002	Upgrade - Stainless steel anchor with chain	2.590 €
XC9101	Delta-anchor 16 kg, stainless steel, with 'Power Ball' swivel and 50 m stainless steel chain	
<hr/>		
XW3003	Upgrade - bathing platform with swimming stairs	1.790 €
XC6002	Bathing platform, manual fold-out with swimming stairs	
<hr/>		
XW4000	Performance Package	7.290 €
XC2201	2 GRP steering wheels, Y-spoke (black or white)	
XE3005	QUANTUM AC5 performance sails - full battened, triradial, main and jib	
XE9001	Dyneema halyards for main and jib	
XE9002	Mainsail slider system	
<hr/>		
XW4001	Upgrade - Secondary Winches	2.290 €
XC5200	2 LEWMAR 45 ST EVO manual secondary winches	
<hr/>		
XW4100	Gennaker Package	4.790 €
XE3105	QUANTUM Gennaker (colour selection - only with XC9161)	
XE3110	Squeezer for Gennaker	
XE9003	Gennaker/Crossover package incl. halyard, 2 sheets, 2 blocks and padeyes (only with XC9161)	
<hr/>		
XW5000	Comfort Package	4.490 €
XC9032	Courtesy lights in cockpit	
XC9033	Courtesy lights at companionway	
XC9300	2 vents for coach roof hatches	
XL9003	Indirect lights in saloon and cabins	
XL9004	LED overhead lights in saloon and master cabin, dimmable	
XL9010	SLS - Scenario light system - touch screen controller and dimmer in saloon	
XN2500	Cockpit cushions (colour selection)	
XV9010	Blind set with flyscreens for deck hatches	

XV9060	Blinds for hull windows
XV9080	Blinds for side coach roof windows

XW6500	Smart Connection Package	2.990 €
---------------	---------------------------------	----------------

XF4655	Interior camera
XK5031	WLAN router incl. booster antenna

XW7000	Entertainment Package	2.090 €
---------------	------------------------------	----------------

XH2090	Wireless charging
XK1000	FUSION MS-RA70N Multimedia radio with bluetooth - for saloon and cockpit (only with XK5000)
XK2000	2x 2 speakers in saloon and cockpit
XK3070	FUSION MS-NRX remote control in cockpit

XW7001	Upgrade - Premium Radio	790 €
---------------	--------------------------------	--------------

XK1001	FUSION APOLLO MS-RA770 Multimedia radio with Wi-Fi and touchscreen - for saloon and cockpit (only with XK5000)
XK3071	FUSION MS-ERX400 remote control in cockpit
XK5030	FUSION wireless link - remote control via mobile devices

XW7030	TV Package - Saloon	1.690 €
---------------	----------------------------	----------------

XK4040	TV preparation in saloon
XK4140	LED TV flat screen in saloon
XK5020	DVB-T2 antenna for TV

OPTIONS

excl. VAT

HULL

XA1001	GRP hull, gelcoat colour: Grey (similar RAL 7040)	3.790 €
XA3001	Waterline and cove line, coloured gelcoat (colour selection)	590 €

KEEL

XB1001	L-keel, cast iron, draft: 1.74 m	2.990 €
XB9000	Keel and rudder - not mounted	790 €

LAYOUT & INTERIOR

XL1002	A2: Master cabin with separate head, double V-berth and storage space	4.290 €
XL2002	B2: Saloon with short L-galley, dining area on stb and sofa on port - separate head with shower stall on port (only with XL3002 or XL3003)	990 €
XL3002	C2: 2 aft cabins with double berth and storage space (only with XL2002)	2.790 €
XL3003	C3: Aft cabin with double berth and storage space on port, utility room and separate shower stall on stb (only with XL2002)	2.290 €
XL7200	Chart table lowerable and seat in saloon convertible into double berth	2.290 €
XL7601	Worktop in galley - Seashell White	690 €

WOOD (FURNITURE, FLOORBOARD)

XM1101	Furniture - Canadian Chestnut	4.090 €
XM1102	Furniture - Teak	4.090 €
XM1104	Furniture - French Oak	4.090 €
XM1161	Cupboard fronts coloured (partial as per design - colour selection)	1.190 €
XM1201	Floorboard - Classic Stripes	1.890 €
XM1202	Floorboard - Noce Nero	890 €
XM1203	Floorboard - Delight Oak	890 €

UPHOLSTERY

XN2001	Upholstery - Sorrento (colour selection)	890 €
XN2002	Upholstery - Florence (colour selection)	1.290 €
XN2003	Upholstery - Monaco (colour selection)	1.690 €
XN2004	Upholstery - Portofino Leather (colour selection)	3.890 €
XN2400	Sun bed cushions on coach roof (colour selection)	1.190 €
XN2500	Cockpit cushions (colour selection)	1.390 €
XN2503	Cushions for helmsman seat (colour selection)	490 €

DECK & OUTSIDE EQUIPMENT

XC1300	Real teak on side deck	12.990 €
XC1301	Synthetic teak on side deck (colour selection)	13.290 €
XC1310	Real teak on coach roof	3.890 €
XC1311	Synthetic teak on coach roof (colour selection)	3.990 €
XC2201	2 GRP steering wheels, Y-spoke (black or white)	1.790 €

XC3003	Cockpit table with stowage and optional fridge	990 €
XC3010	Fridge for cockpit table (only with XC3003)	790 €
XC4001	Gateway stanchion	990 €
XC5102	2 LEWMAR 45 EST EVO electrical halyard winches with automatic fuse (only with XH1001)	7.040 €
XC5200	2 LEWMAR 45 ST EVO manual secondary winches	2.690 €
XC9020	Rub rail, teak	1.490 €
XC9161	Anchor and forestay fitting with double mooring roll incl. gennaker/crossover eye	890 €
XC9404	2 openable hatches in deck windows next to companionway	1.490 €

RIG & SAILS

XE1001	Mast, anodized aluminium with manual inmast furling system	2.990 €
XE2001	Lazy bag with lazy jacks (colour selection - not with XE1001)	1.190 €
XE2012	Sprayhood with stainless steel stake, 3 windows (1 openable - colour selection)	2.840 €
XE2021	Bimini with stainless steel stake (colour selection)	3.490 €
XE3001	QUANTUM Blue Water Dacron sails - full battened, main and jib (with XE1001 no battens)	1.690 €
XE3005	QUANTUM AC5 performance sails - full battened, triradial, main and jib	5.290 €
XE3300	QUANTUM CZ Crossover sail - with CX endless furler and storage bag (only with XC9161)	6.290 €
XE9001	Dyneema halyards for main and jib	1.090 €
XE9003	Gennaker/Crossover package incl. halyard, 2 sheets, 2 blocks and padeyes (only with XC9161)	1.090 €

NAVIGATION & INSTRUMENTS

XF3000	B&G VHF V60 at chart table, incl. wireless remote handset H60 (only with XK5000)	1.190 €
XF4000	B&G Zeus³S 9" chart plotter at chart table	3.390 €
XF4500	B&G HAL020+ Broadband Radar (only with chart plotter)	3.890 €
XF4560	MyHanse Safety Cloud hardware with 30 days free trial subscription and an interior light, switchable by APP	1.290 €
XF4600	B&G AIS Class B transponder (only with chart plotter and XK5000)	1.590 €

PROPULSION

XG1001	Engine (Diesel, approx. 39 hp) - saildrive, 2-blade folding propeller	1.790 €
XG1103	Engine (Diesel, approx. 57 hp) - saildrive, 3-blade folding propeller	6.390 €
XG3101	Bowthruster, 12 V, retractable, incl. battery	9.090 €

EQUIPMENT

XH1110	Deep charge protection for service batteries	1.390 €
XH1601	Country Version: US / JPN	1.490 €
XH2201	Inverter/charger, incl. larger AC panel (only with XH1001)	2.790 €
XH3001	Electric toilet with sea water flush - cabin layout B	1.390 €
XH3011	Electric toilet with sea water flush - cabin layout A2	1.390 €
XH4011	Heating, hot air with blowers in saloon and master cabin	4.390 €
XH4021	Outlet for heating in aft cabin port (only with XH4011 and layout C1)	490 €
XH4022	Outlet for heating in aft cabins (only with XH4011 and XL3002 or XL3003)	690 €
XH4511	Air conditioning, 12.000 BTU, 1 unit: saloon and master cabin, incl. 2nd shore power	10.390 €
XH4514	Air conditioning, 8.000 BTU, 1 unit: aft cabin, incl. 2nd shore power	6.990 €
XH5110	Additional fridge in galley (only with layout B1 and XH1001)	2.190 €
XH5150	Microwave in galley	990 €
XH5409	Gas leak detector	990 €
XH5610	Grey water system "Lakes" for bathrooms and galley, tank: 100 l - no hull-through fittings for grey and black water, fresh water capacity reduced	1.690 €
XH6001	Grey water system for bathrooms and galley, tank: 100 l - fresh-water capacity reduced	1.890 €

RADIO & ENTERTAINMENT

XK5000	VHF preparation with antenna and splitter for FM and AIS	490 €
--------	--	-------

ACCESSORIES

XV9120	Cockpit table cover (colour selection)	540 €
XV9130	Cover for steering wheels (colour selection)	540 €
XV9380	Shrink wrap foil (for storage purpose only / not for transport)	590 €

SHIPPING & TRANSPORT

XZ2001	Loading on truck	590 €
XZ2003	Oversea shipping pack (cradle)	3.390 €
XZ2020	Ready for pickup	690 €

All mentioned prices in €, basic prices ex yard and excl. VAT. All weights and measures are calculated numbers based on the construction data. Changes in construction and equipment reserved.
 Above mentioned prices are recommended for ex yard deliveries within 4 month after order confirmation. For later delivery time the company reserves right to apply latest price list. Company reserves additional 15 working days when painted hull or deck is ordered. All measurements/figures are approximate. Errors and omissions excepted. Specification and material can be changed without notice.
 Valid from 2025.04.04