

# SPECIFICATION + PRICELIST



## technical details

according to ISO 8666

LOA	12.81 m	42' 0"
LOA - ext. fixed platf.	13.51 m	44' 4"
LOA - ext. high low platf.	13.79 m	45' 3"
Hull length	12.15 m	39' 10"
Beam	3.99 m	13' 1"
Draft max	1.17 m	3' 10"
Water tank	335 l	74 UK gal
Fuel tank	900 l	198 UK gal
Displacement	11.56 t	11.38 UK t
CE Category - max. persons	B -12	C -14
Engine Standard		
2x Volvo Penta D6-340	ca.	30 Kn*(TBC)
Engine Options		
2x Volvo Penta D6-380	ca.	33 Kn* (TBC)
2x Volvo Penta D6-440	ca.	38 Kn* (TBC)



\*All performance figures are given in good faith and are intended as an indication. These figures cannot be guaranteed as top speed in particular is affected by the cleanliness of the hull, conditions of the propellers, weight carried and air/sea temperature. Performance is related also to the optional accessories selected. "TBC" stays for: To Be Confirmed after seatrial. FJORD reserves the right to change specifications in line with the company policy of improvement through research and development. Standard Propeller tested in Greifswald according to Volvo conditions. All measurements/figures approximate. Errors and omissions excepted. Specification and material can be changed without notice. Please check with your dealer for a full list of inclusions. Valid from 2025.08.01

# EXTERIOR LAYOUTS



*Standard  
T-Top*



*Standard*



*Option*

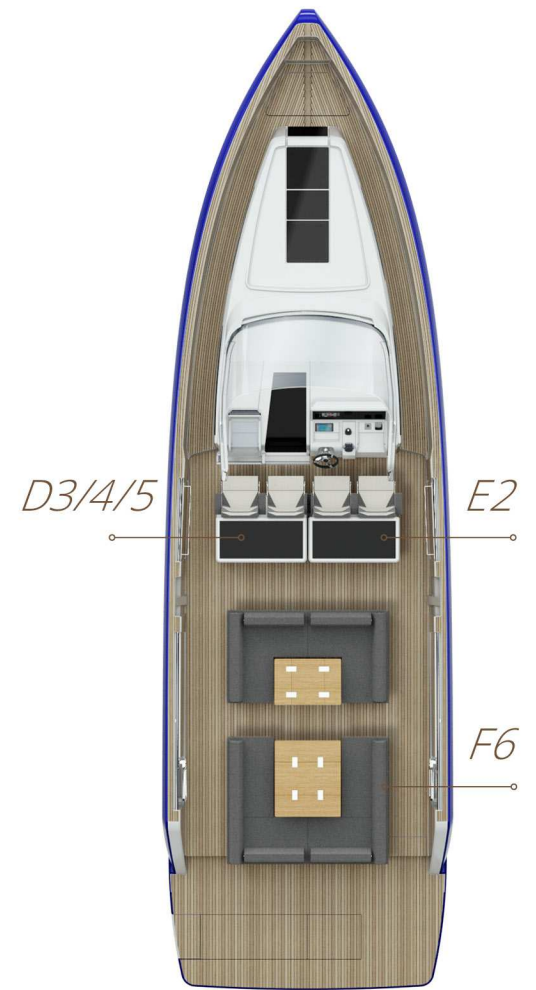

*Option*

# INTERIOR LAYOUTS

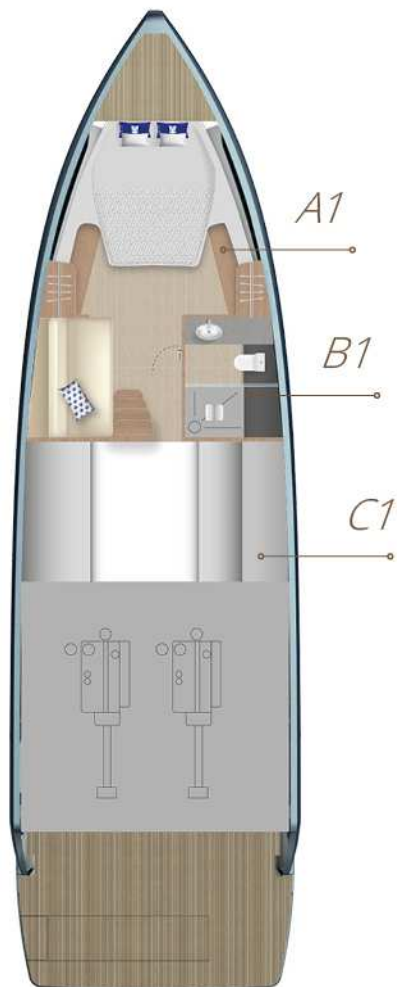

*Standard*

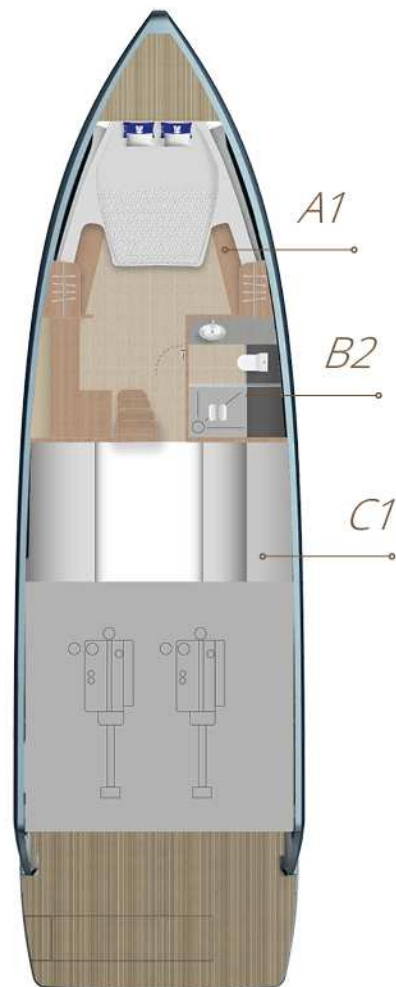

*Option*

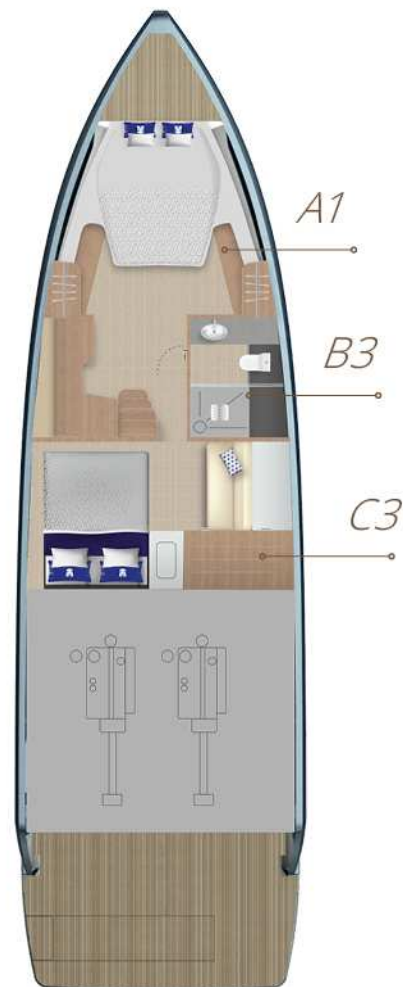

*Option*

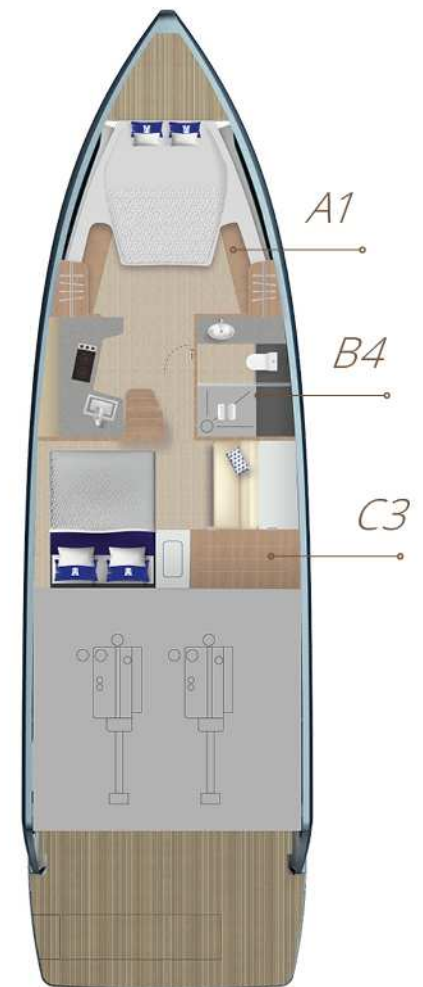

*Option*

# STANDARD EQUIPMENT

## HULL

- / GRP hull, isophthalic gelcoat, colour: signal white (according to colour card), 1st layer vinyl ester resin.
- / Waterline, isophthalic gelcoat, colour: jet black (according to colour card)
- / Openable portholes in master cabin and toilet

## DECK & COCKPIT

- / Dashboard, colour: signal white (according to colour card), with foot support, handrail, glovebox, cupholder, horn, switch panel, engine room fire extinguisher system, 2 emergency fuel cut off, place for ipad in dashboard
- / GRP deck, isophthalic gelcoat, colour: signal white (according to colour card), 1st layer vinyl ester resin. Stainless steel tie bar for fender. Large diameter stainless steel handrails, wire guardrail at stern. Fold out stairs on port side and starboard bulwark. Sunpad at bow.
- / Synthetic teak on deck, bathing platform and gunwale (according to colour card)
- / Place for fender storage at bow.
- / FJORD steering wheel with tilting system
- / Windshield, open to the top
- / Bathing platform with telescopic bathing ladder, integrated in bathing platform
- / Manual engine hatch
- / 6 aluminium mooring cleats, stainless steel handrails
- / Shower unit with hot and cold water
- / Pilot and Copilot seats with hinged bolster
- / T-Top with windshield frame and wiper cover, gelcoat finishing, colour: white

## PROPULSION

- / Engine room, sound insulated, fans, fire extinguisher system, automatic and manual, Batteries-Engines: 2 x 90 Ah / 12 V, Battery charger (for engine and service batteries)

- / 2 Volvo Penta D6-340/DPI (250 kW) with joystick, propeller TBC, 2 Volvo 2,5" engine displays
- / Volvo Penta BTS (boat trim system), manual
- / Fuel tank, capacity: 900 litres, fuel filter

## ELECTRICAL EQUIPMENT

- / 12 V and 230 V electric system with 230 V shore power connection 15 A. Sockets in master cabin (2), toilet (1), lobby area (1), utility room (1) engine room (1) and 12V on dashboard (1)
- / Batteries-Service: 2 x 160 Ah AGM
- / Country Version: EU / AUS
- / Wireless charging for mobile phone in cabin (2)
- / Electric toilet
- / Dimmable spotlights, indirect lights in master cabin. Light in toilet, in storage room and in engine room.
- / Holding tank, capacity: 62 litres
- / Water tank, capacity: 335 litres
- / Hot water boiler and pump
- / Bilge pumps: automatic electric (2) and manual emergency bilge pump in cockpit (1)

## LAYOUT & INTERIOR

- / A1: Master cabin with double berth, 2 wardrobes, sideboards, 2 drawers underneath the bed. 3 skylights, 2 of them openable. Fully equipped head with separate shower stall with rain and handheld shower.
- / B1: Lobby with small sofa and drawer fridge (35 l) underneath
- / C1: Storage room with light

## EXTERIOR MODULES

- / D1: Galley module port side 660 mm with cover, fridge (65 l), working top in marine mineral stone and 1 additional copilot seat with cover

- / E2: Pilot and copilot seat with galley module sb side 1240 mm with cover, sink with folding mixing tap and storage, working top in marine mineral stone
- / F2: Sunbed 2138 mm with storage and 2 drawer fridges, 2 benches with backrest and 2 x 1040 mm benches incl. cover + 2 foldable tables with electrical high low table leg and upholstery on top, incl. cover and access to the storage room electrical openable

## UPHOLSTERY & WOOD

- / Upholstery and covered mattress scheme: porto bello, colour: cream (according to colour card)
- / Exterior upholstery and helmsman seats - Hitch, colour: Starfish (according to colour card)
- / Soft material horizontal surface around the bed in the owner cabin and vertical panels around the bed in owner and guest cabin, colour: snow
- / Interior furniture in high quality marine plywood, colour: warm mahogany (according to colour card)
- / Flooring in all cabins - pale acacia (according to colour card)

## TRANSPORT

- / Identified locations for hand held fire extinguishers - (hand held fire extinguishers are not supplied), FJORD Owner's Manual in FJORD document bag



# PRICELIST



## AS PER STANDARD SPECIFICATION

excl. VAT  
659.100 €

### PROPULSION

XC2000	2 Volvo Penta D6-340/DPI (250 kW) with joystick, propeller TBC	Standard
XC2010	2 Volvo Penta D6-440/DPI (324 kW) with joystick, propeller H6	50.950 €
XC2100	Volvo Penta active corrosion protection for sterndrives (only with Volvo engine and not with XB3502)	5.950 €
XC5101	Volvo Interceptor System with Auto trim, List and Coordinated Turn, with Volvo Penta multifunction 7" display (only with Volvo engine)	16.800 €
XC5102	Humphree Interceptor System with Auto trim, List and Coordinated Turn. Humphree Control Panel with High resolution colour LCD display (not with Volvo engine)	16.800 €
XC6001	Bowthruster	6.250 €

### PACKAGES

<b>XW1005</b>	<b>Cover Package</b>	<b>3.700 €</b>
XV1004	Cover for companionway (according to colour card)	
XV1005	Cover for dashboard (according to colour card)	
XV1007	Cover for sunbed at bow (according to colour card)	
<b>XW2000</b>	<b>Upholstery Package ECO</b>	<b>10.350 €</b>
XU1005	Upholstery - ECO (according to colour card)	
XU1023	Exterior upholstery and helmsman seats - ECO (according to colour card)	

## **XW3000 Smart Connection Package 5.000 €**

XE3110	WLAN router
XN3800	Interior camera

## **XW5000 Light Package (only with F2 standard layout) 8.900 €**

XD4001	Courtesy lights on side decks
XD4051	Indirect light: multicolour on handrails on side deck and sunbed and white colour on dashboard (driven by IOS or Android App)

## **XW7000 JL Entertainment Package (not with XW7001) 5.450 €**

XE2001	JL Audio MM50 inside
XE2101	2 JL M6 770X-L speakers inside
XE2102	2 JL M6 770X-L speakers at helm position
XE2201	JL Audio MMR-40 remote control in cockpit

## **XW7001 JL Ultimate 3-zone Entertainment Package (not with XW7000) 13.850 €**

XE2001	JL Audio MM50 inside
XE2002	JL Audio MM100 BE in cockpit
XE2058	1 JL Audio M800/8v2 amplifier and 1 JL Audio M600/1 amplifier with 2 JL M6 101B-L subwoofer
XE2101	2 JL M6 770X-L speakers inside
XE2102	2 JL M6 770X-L speakers at helm position
XE2103	2 JL M6 770X-L speakers at foredeck

# PRICELIST



XE2104	2 JL M6 770X-L speakers in cockpit				
XE2207	JL Audio MMR-40 remote control at foredeck				
<b>OPTIONS</b>		excl. VAT			
<b>HULL</b>					
XA1001	GRP hull, painted, non metallic (according to colour card)	33.200 €			
XA1002	GRP hull, painted, metallic (according to colour card)	46.650 €			
XA2001	Waterline, painted, non metallic (according to colour card)	4.350 €			
XA2002	Waterline, painted, metallic (according to colour card)	6.050 €			
<b>DECK &amp; COCKPIT</b>					
XB1006	Dashboard on sb side and p side, painted, non metallic (according to colour card)	5.700 €			
XB1007	Dashboard on sb side and p side, painted, metallic (according to colour card)	7.200 €			
XB1056	Synthetic teak on deck, bathing platform and gunwale (according to colour card)	Standard			
XB1055	Real teak on deck, bathing platform and gunwale	14.650 €			
XB3000	Passerelle, retractable incl. remote control	25.700 €			
XB3501	Longer fixed bathing platform (1.19 m) incl. foldable bathing stairs with handle	15.550 €			
XB3502	Longer bathing platform (1.19 m) with hydraulic lift, integrated ladder and bathing ladder with handles, stand alone	27.200 €			
XB3560	Handrail at the end of the sunbed (only with XM3001)	1.200 €			
XB3555	Handrail on bow sunpad area on sb side and p side	1.090 €			
XB4036	Anchor system slide out incl. stainless steel anchor 15 kg and 100 m stainless steel chain, windlass with automatic fuse and camera at bow - anchor facing (only with XN1001 or XN1005)	21.250 €			
XB4110	Anchor chain counter	800 €			
XB4121	2 retractable cleats on bathing platform for Dinghy/Jetski (not suitable for towing or mooring)	1.400 €			
XB4300	Freshwater shore connection at stern	600 €			
XB4310	Freshwater wash down connection at bow	1.200 €			
XB4400	6 fender pins	1.200 €			
XB3291	Extended windshield up to the T-Top	4.050 €			
XB9010	T-Top with windshield frame and wiper cover, painted, non metallic (according to colour card)	34.000 €			
XB9020	T-Top with windshield frame and wiper cover, painted, metallic (according to colour card)	51.000 €			
<b>ELECTRICAL EQUIPMENT</b>					
XD1002	Battery set, capacity: 2x 90 Ah + 4x 160 Ah AGM	3.350 €			
XD1010	Battery set, Lithium, capacity: 2x 460 Ah	15.650 €			
XD1012	Battery set, Lithium, capacity: 4x 460 Ah	35.400 €			
XD1110	Deep charge protection for service batteries	1.450 €			
XD2001	Inverter/Charger (only with XD1002, XD1010 or XD1012)	4.700 €			
XD3300	Anti Rolling Gyro 220 V (only with XD3001)	37.250 €			
XD1601	Country Version: US / JPN	4.250 €			
XD3001	Fischer Panda generator 10000i, 8.0 kW	21.200 €			

# PRICELIST



XD4011	4 underwater multicolour lights (blue, green, red and white) on transom	5.700 €
XD6011	Air conditioning, incl. 2nd shore power (recommended option: generator) (only with layout C3 which is chilled)	25.400 €
XD8010	Greywater tank	4.100 €

## NAVIGATION & INSTRUMENTS

XN2101	Simrad VHF RS100, with VHF antenna and splitter for FM/AIS	2.050 €
XN1001	Simrad multifunction display NSS evo3S-12" at dashboard with DST transducer (not with XN1005)	6.700 €
XN1005	Simrad multifunction display NSS evo3S-16" at dashboard with DST transducer (not with XN1001)	8.900 €
XN1011	Additional Simrad multifunction display NSS evo3S-16" at dashboard (only with XN1005)	6.650 €
XN2001	Simrad HALO20+ Radar (only with XN1001 or XN1005)	5.000 €
XN2002	Simrad HALO20+ Radar dome, painted (according to colour card - only with XN2001)	3.150 €
XN3500	Simrad NAIS500 (only with XN1001 or XN1005)	2.400 €
XN3560	MyFJORD Safety Cloud hardware with 30 days free trial subscription and an interior light, switchable by APP	1.550 €
XN3700	Simrad Sonarhub Sounder and HDI Transducer (only with XN1001 or XN1005)	2.650 €
XN3805	Camera in engine room (only with XN1001 or XN1005)	1.950 €
XN3001	Simrad Autopilot with electronic compass (only with XN1001 or XN1005)	7.900 €

## LAYOUT & INTERIOR

XL1001	A1: Master cabin with double berth, 2 wardrobes and head with separate shower	Standard
XL2001	B1: Lobby with small sofa and drawer fridge (35 l) underneath	Standard
XL2002	B2: Storage furniture with drawer fridge (90 l) and drawer freezer (90 l)	4.750 €
XL2003	B3: Vanity area with seat, storage furniture and fridge (65 l)	5.250 €
XL2004	B4: Galley with electric cooktop 2-rings and increased 30 A shore power connection, fridge (65 l), sink with draining basin and sliding door to master cabin in main bulkhead and larger wardrobe on p side in master cabin	14.950 €
XL3001	C1: Storage room with light	Standard
XL3003	C3: Guest cabin with double berth, sofa, wardrobe and 3 openable portholes in deck	12.000 €
XL7300	Sliding door to master cabin in main bulkhead and larger wardrobe on p side in master cabin (only with layout B1, B2 or B3)	3.600 €
XL7301	Door to storage room or guest cabin	2.400 €

## EXTERIOR MODULES

XM1000	D1: Galley module port side 660 mm with cover, fridge (65 l), working top in marine mineral stone and 1 additional copilot seat with cover	Standard
XM1002	D2: Galley module port side 660 mm with cover, gas BBQ, working top in marine mineral stone and 1 additional copilot seat with cover	1.100 €

# PRICELIST



XM9000	For D1 and D2: Galley module port side 660 mm, painted, non metallic (according to colour card)	5.700 €
XM9005	For D1 and D2: Galley module port side 660 mm, painted, metallic (according to colour card)	6.500 €
XM1003	D3: Galley module port side 1240 mm with cover, fridge (65 l), storage, working top in marine mineral stone and 2 additional copilot seats with cover	5.900 €
XM1004	D4: Galley module port side 1240 mm with cover, 2 fridges (65 l each), working top in marine mineral stone and 2 additional copilot seats with cover	7.200 €
XM1005	D5: Galley module port side 1240 mm with cover, fridge (65 l), gas BBQ, working top in marine mineral stone and 2 additional copilot seats with cover	7.200 €
XM9010	For D3, D4 and D5: Galley module port side 1240 mm, painted, non metallic (according to colour card)	7.200 €
XM9015	For D3, D4 and D5: Galley module port side 1240 mm, painted, metallic (according to colour card)	8.300 €
XM9020	For E2: Galley module sb side 1240 mm, painted, non metallic (according to colour card)	7.200 €
XM9025	For E2: Galley module sb side 1240 mm, painted, metallic (according to colour card)	8.300 €
XM8003	For E2: Stove with 2 burners, induction ceran, electric 230 V, and increased 30A shore power connection (recommended option: generator)	3.050 €

XM8005	For F2: 2 drawer fridges in the 2 x 1040 mm benches	5.000 €
XM3005	F6: 6 x 1040 mm benches, 2 x 592 mm benches, 2 drawer fridges, 2 tables foldable with high low leg and upholstery on top, cover for everything and engine hatch	9.600 €

## UPHOLSTERY & WOOD

XU1080	Fiberglass decor parts, painted, non metallic (according to colour card)	2.950 €
XU1081	Fiberglass decor parts, painted, metallic (according to colour card)	3.350 €
XU1041	Soft material horizontal surface around the bed in the owner cabin and vertical panels around the bed in owner and guest cabin (according to colour card)	1.950 €
XU1001	Upholstery - smooth (according to colour card)	1.400 €
XU1002	Upholstery - dash (according to colour card)	2.150 €
XU1003	Upholstery - padua (according to colour card)	2.050 €
XU1004	Upholstery - scoop leather (according to colour card)	3.050 €
XU1021	Exterior upholstery and helmsman seats - Hitch (according to colour card)	1.600 €
XU1022	Exterior upholstery and helmsman seats - Dolce Vita (according to colour card)	3.950 €
XU1024	Exterior upholstery and helmsman seats - Classic style with stitching in Hitch (according to colour card)	5.100 €
XU1025	Exterior upholstery and helmsman seats - Sport style with bicolor material: main surface in Hitch (according to colour card) and ornament stripes in Hitch (according to colour card)	6.700 €



# PRICELIST



XU1050	Bow sunpad with manual liftable backrest	5.100 €
XU5001	Furniture - atlanta walnut (according to colour card)	3.700 €
XU5002	Furniture - milano oak (according to colour card)	4.750 €
XU5003	Furniture - lisboa chestnut (according to colour card)	5.350 €
XU5004	Furniture - painting interior, colour: signal white (similar RAL 9003) / high gloss finish (according to colour card)	33.800 €
XU5005	Furniture - painting interior, colour: telegrey (similar RAL 7047) / high gloss finish (according to colour card)	33.800 €
XU5100	Furniture - HIGH GLOSS FINISH (only with XU5001 or XU5003)	6.800 €
XU6011	Floorboard - noce nero (according to colour card)	750 €
XU6012	Floorboard - eternal oak (according to colour card)	1.100 €
XU6013	Floorboard - basque oak (according to colour card)	1.100 €

## ACCESSORIES

XV2000	Sun awning, aft, with side extension incl. poles, colour: black or white	5.650 €
XV2010	Sun awning, fwd, manual incl. poles, colour: black or white	4.150 €
XV2035	Electric bimini in T-top: mesh, colour: black or white	13.350 €
XV2036	Electric bimini in T-top, with side and stern sun protection: mesh, colour: black or white	16.450 €
XV5001	6 cushion fenders	1.400 €
XV5201	Windshield wiper	2.850 €
XV9060	Blinds for deck and hull windows	5.900 €
XV9910	Safe	950 €

## TRANSPORT

XZ2001	Loading on truck with disassembled deck parts and antennas	800 €
XZ2010	Oversea shipping cradle	4.150 €
XZ2020	Ready for pickup	650 €

All mentioned prices in €, basic prices ex yard and excl. VAT. All weights and measures are calculated numbers based on the construction data. Changes in construction and equipment reserved. Above mentioned prices are recommended for ex yard deliveries within 4 month after order confirmation. For later delivery time the company reserves right to apply latest price list. Company reserves additional 15 working days when painted hull or deck is ordered. All measurements/figures are approximate. Errors and omissions excepted. Specification and material can be changed without notice. Valid from 2025.08.01