

SPECIFICATION & PRICELIST

Dehler  **42**



TECHNICAL DATA

LOA	12.84 m / 42' 2"
HULL LENGTH	12.42 m / 40' 9"
LWL	11.50 m / 37' 9"
BEAM	3.91 m / 12' 10"

DRAUGHT	
standard	2.15 m / 7' 1"
L-keel medium	2.16 m / 7' 1"
competition	2.38 m / 7' 10"
shallow keel	1.98 m / 6' 6"

BALLAST	
standard	3.00 t / 6,614 lbs
L-keel medium	3.00 t / 6,614 lbs
competition	2.60 t / 5,732 lbs
shallow keel	3.25 t / 7,165 lbs

DISPLACEMENT	
standard	9.10 t / 20,062 lbs
L-keel medium	9.20 t / 20,282 lbs
competition	8.70 t / 19,180 lbs
shallow keel	9.50 t / 20,943 lbs

ENGINE APPROX.	Diesel 29 PS / hp
-----------------------	-------------------

FRESH WATER	approx. 295 l / 77.93 gal
--------------------	---------------------------

FUEL TANK	approx. 160 l / 42.27 gal
------------------	---------------------------

MAST ABOVE WL	
standard	19.50 m / 63' 12"
competition	20.25 m / 66' 4"

TOTAL SAIL AREA	
standard	91.80 m² / 988 sq ft
competition	95.30 m² / 1,026 sq ft

MAIN SAIL	
standard	52.30 m² / 563 sq ft
competition	54.00 m² / 581 sq ft

FURLING JIB 105%	
standard	39.50 m² / 425 sq ft
competition	41.30 m² / 445 sq ft

SPINNAKER	
competition	142.40 m² / 1,533 sq ft

GENNAKER	
standard	122.20 m² / 1,315 sq ft
competition	145.00 m² / 1,561 sq ft

FREERIDE	
standard	93.00 m² / 1,001 sq ft
competition	95.00 m² / 1,023 sq ft

RIG	
standard	I 16.44 m / 53' 11"
	J 4.63 m / 15' 2"
	P 16.10 m / 52' 10"
	E 5.70 m / 18' 8"
competition	I 16.90 m / 55' 5"
	J 4.63 m / 15' 2"
	P 16.90 m / 55' 5"
	E 5.80 m / 19' 0"

CE CERTIFICATE	A - 10
-----------------------	--------

DESIGN	judel/vrolijk & co.
---------------	---------------------

INTERIOR	Dehler
-----------------	--------

All measurements/figures are approximate. Errors and omissions excepted. Specification and material can be changed without notice. Valid from 2023.01.01 for deliveries until 2023.12.31.

DECK AND INTERIOR LAYOUTS

Dehler  **42**

DECK LAYOUT

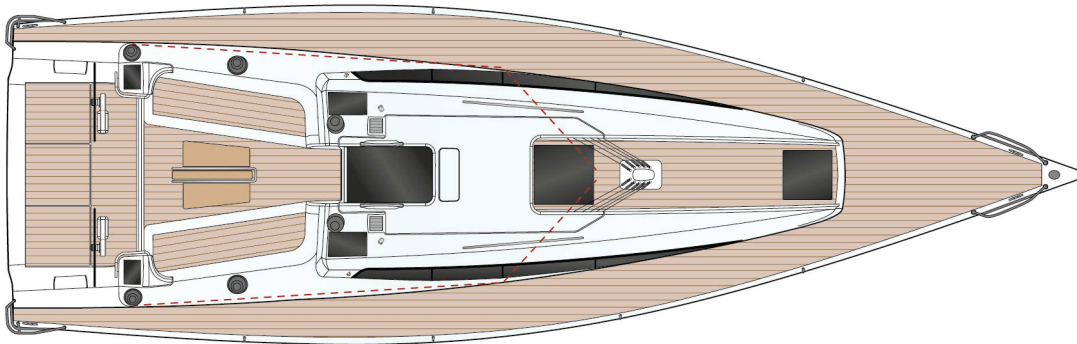

INTERIOR LAYOUT

STANDARD

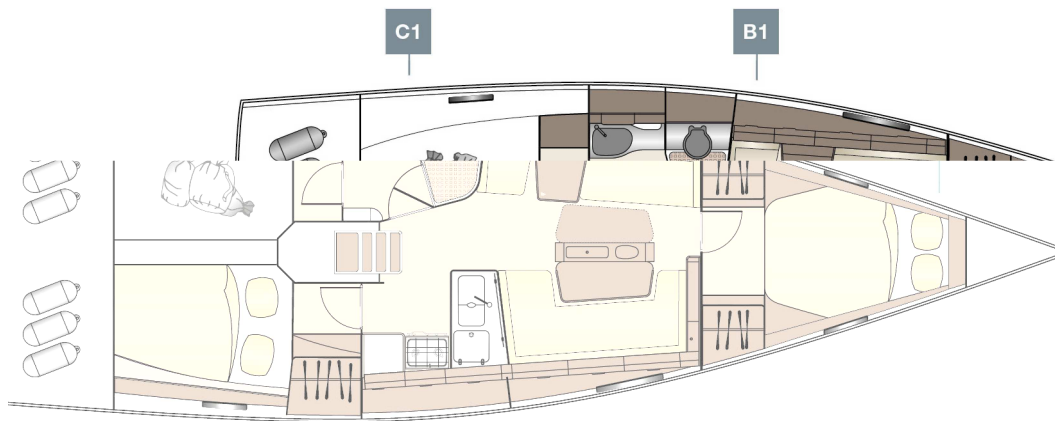

OPTION

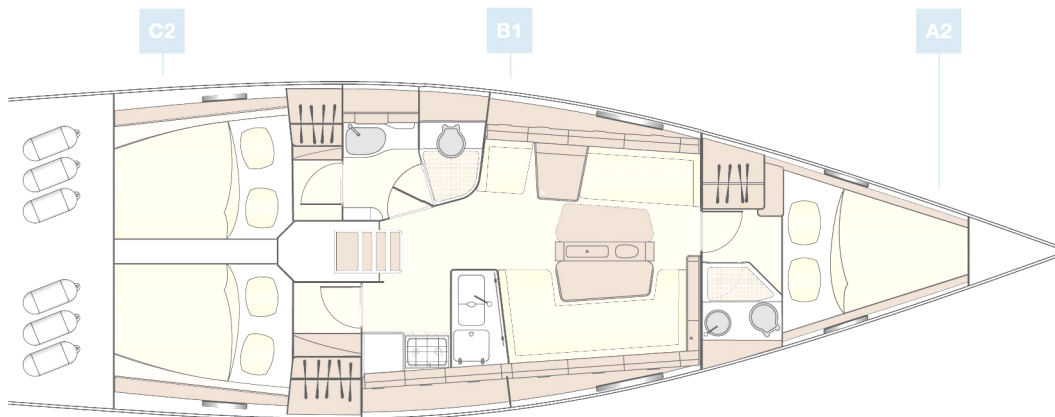

HULL

- 6 hull windows (3 each side)
- GRP hull, isophthalic gelcoat, colour: Signal White (RAL 9003), 1st layer vinylester resin with PVC foam core built in vacuum infusion
- Waterline and cove line, isophthalic gelcoat, colour: Dark Blue (RAL 5004)

KEEL

- T-keel, cast iron, standard draft: 2.15 m
- GRP rudder with sea-water resistant aluminium shaft and selfaligning bearings

LAYOUT & INTERIOR

- A1: Master cabin with double V-berth, hanging locker and shelves
- B1: Saloon with L-galley, dining area on stb and sofa with sliding chart table on port - separate head with shower stall on port
- C1: Aft cabin with double berth, locker and storage on stb, large storage space on port with entrance from head
- 2-burner gas stove, waste bin, 12 V fridge approx. 130 l, double stainless steel sink with mixing tab
- Interior furniture in high quality marine plywood, satin varnish
- Dehler companionway closing system
- Saloon table, folding with stowage
- Worktop in galley, White
- SLS - Scenario light system touch screen controller with dimmer for saloon

WOOD (FURNITURE, FLOORBOARD)

- Furniture - Mahogany
- Floorboard - Australian Acacia

UPHOLSTERY

- Mattresses for all berths
- Upholstery - Baltic, colour: creme
- Upholstery - Piping (colour selection)

DECK & OUTSIDE EQUIPMENT

- GRP deck with antislip surface, isophthalic gelcoat, colour: Signal White (RAL 9003), 1st layer vinyl ester resin with balsa sandwich core. Cockpit locker on port, stern lockers on port and stb, anchor locker at bow.
- Cockpit bottom, gelcoat colour: Signal White (RAL 9003)
- Teak on coach roof
- Teak on cockpit benches
- Twin wheel steering system with emergency tiller
- 2 stainless steel steering wheels with leather cover
- Pulpit and pushpit, stainless steel
- Railing, incl. stanchions and stainless steel wire
- Halyards and control lines with organizers and jammers on coach roof, 4 retractable mooring cleats, handrails on coach roof
- 2 LEWMAR 45 Race manual halyard winches
- 2 LEWMAR 45 Race manual secondary winches
- 2 LEWMAR 45 Race manual mainsheet winches
- Swimming ladder

- Life raft storage
- Rub rail, aluminium
- Bow fitting with anchor roller
- Genoa tracks, incl. cars, adjustable from cockpit
- German mainsheet system with adjustable traveller
- 4 deck hatches - openable, anchor locker hatch
- 6 deck coach roof windows - openable, portlights in cockpit sides for aft cabins

RIG & SAILS

- Rig, anodized aluminium, keel stepped incl.: dyform rigging, running rigging, kicker, manual jib furler below deck, "Dehler Quick Reefing System", manual backstay tensioner
- QUANTUM AC5 performance sails - full battened, triradial, main and jib
- Dyneema halyards for main and jib

NAVIGATION & INSTRUMENTS

- 2 illuminated compasses at steering pedestal
- Navigation lights - LED

PROPULSION

- Fuel tank, approx. 160 l
- Engine (Diesel, approx. 29 hp) - saildrive, 2 blade folding propeller

EQUIPMENT

- 12 V and 230 V electric system with main panel, 12 V and 230 V socket and 230 V shore power.
- AGM battery set - capacity: Starter battery: 1 x 90 Ah, service battery: 1 x 160 Ah
- Country Version: EU / AUS
- Battery charger 35 A
- Manual toilet with sea water flush - cabin layout B
- Shower unit in cockpit, warm-/coldwater
- LPG gas system, stowage for 1 bottle
- Manual and electric bilge pump
- Black water system (appr. 35 l) with deck extraction and seacock for head
- Fresh water system with electric pump and 20 l hotwater, heated also by main engine
- Fresh water tank, appr. 295 l

SHIPPING & TRANSPORT

- CE - Certificate cat. A - 10
- Owners manual
- EC - Type Examination Certificate

AS PER STANDARD SPECIFICATION

excl. VAT
267.900 €

PACKAGES

XW2010	B&G Navigation Package - Cruising	14.390 €
XF2005	Instrument pod on helm station stb	
XF2210	2 B&G Triton ² multifunction displays, 1 per helm station, incl. transducer (wind/depth/speed/temperature)	
XF3000	B&G VHF V60 at chart table, incl. wireless remote handset H60 (only with XK5000)	
XF4040	B&G Zeus ^S 9" chart plotter, stb helm station	
XF5000	B&G Autopilot with Triton ² control unit with WR10 remote control and Precision 9 compass	
XK5000	VHF preparation with antenna and splitter for FM and AIS	
XW2011	Upgrade - Competition	6.290 €
XF2211	2 B&G H5000 multifunction displays, 1 per helm station, incl. transducer (depth/speed/temperature) and wind sensor at vertical carbon mast unit	
XF5001	B&G Autopilot with H5000 control unit with WR10 remote control and Precision 9 compass	
XF5200	B&G CPU Hydra computer (only with B&G H5000 instrument)	
XW2012	Upgrade - second chart plotter	3.090 €
XF2010	Instrument pod on helm station ps	
XF4041	B&G Zeus ^S 9" chart plotter, ps helm station	
XW2013	Upgrade - mast display	4.090 €
XF2240	B&G Nemesis 9" multifunction display at mast	
XW3100	Cruising Package	14.490 €
XC1320	Teak on cockpit bottom	
XC1350	Teak on bathing platform	
XC6001	Bathing platform, manual fold-out with swimming ladder	
XC9070	Halyard bags	
XC9080	2 add. cleats, midship, retractable (1 each side)	
XC9090	Anchor windlass, electrical with automatic fuse, remote control with chain counter (only with XH1001)	
XC9100	Delta-anchor 20 kg, galvanized with 30 m galvanized chain	
XC9300	2 vents for coach roof hatches	
XH1001	Battery set, capacity: 1x 90 Ah + 2x 160 Ah AGM	
XN2510	Head cushions in saloon	
XV9010	Blind set with flyscreens for hatches	
XV9060	Blinds for hull windows	
XV9080	Blinds for side coach roof windows	
XV9420	Wind indicator	
XV9450	Flagpole	
XV9901	6 fenders	
XV9902	4 mooring lines	
XV9950	Dehler maintenance kit	

XW3101	Upgrade - Flexiteek (colour selection)	990 €
XC1311	Flexiteek on coach roof	
XC1321	Flexiteek on cockpit bottom	
XC1341	Flexiteek on cockpit benches	
XC1351	Flexiteek on bathing platform	
XW3102	Upgrade - stainless steel anchor with chain	3.590 €
XC9101	Delta-anchor 20 kg, stainless steel, with 'Power Ball' swivel and 50 m stainless steel chain	
XW4000	Competition Package	6.490 €
XA3004	Cove line - Competition	
XB9101	Rudder - Competition	
XC5104	2 LEWMAR 45 Race Plus manual halyard winches	
XC5201	2 LEWMAR 50 Race manual secondary winches	
XC5304	2 LEWMAR 50 Race Plus manual mainsheet winches	
XC9280	Jib barber hauler with low-friction ring	
XW4001	Upgrade - electric halyard winch	3.190 €
XC5103	2 LEWMAR 45 Race halyard winches, port: manual - stb: electric with automatic fuse (only with XH1001)	
XW4002	Upgrade - Competition Keel	9.990 €
XB1002	T-keel, cast iron/lead, (competition) draft: 2.38 m	
XW4003	Upgrade - Side deck - colour	1.090 €
XC1111	Side decks, gelcoat colour: White Grey (RAL 7047)	
XW4004	Upgrade - Cockpit bottom - colour	890 €
XC1116	Cockpit bottom, gelcoat colour: White Grey (RAL 7047)	
XW6000	Gennaker Package	5.690 €
XE3105	QUANTUM Gennaker (colour selection)	
XE3110	Squeezer for Gennaker	
XE9003	Gennaker/Freeride package incl. halyard, 2 sheets, 2 blocks and padeyes	
XW6001	Upgrade - Competition Gennaker	590 €
XE3107	QUANTUM Gennaker (Competition) (colour selection - only with XE1002)	
XW6500	Smart Connection Package	2.990 €
XF4655	Interior camera	
XK5031	WLAN router incl. booster antenna	
XW7000	Entertainment Package	1.790 €
XK1000	FUSION MS-RA70N Multimedia radio with bluetooth - for saloon and cockpit (only with XK5000)	
XK2000	2x 2 speakers in saloon and cockpit	
XK3000	FUSION MS-NRX remote control in cockpit	

XW7001	Upgrade - premium radio	790 €
XK1001	FUSION APOLLO MS-RA770 Multimedia radio with Wi-Fi and touchscreen - for saloon and cockpit (only with XK5000)	
XK3001	FUSION MS-ERX400 remote control in cockpit	

XW7030	TV Package	2.090 €
XK4040	TV preparation in saloon	
XK4140	LED TV flat screen in saloon	
XK4240	TV lifting system in saloon	
XK5020	DVB-T2 antenna for TV	

OPTIONS

excl. VAT

HULL

XA1001	GRP hull, gelcoat colour: Grey (RAL 7040)	3.990 €
XA1002	GRP hull, painted, non metallic (colour selection)	18.990 €
XA1003	GRP hull, painted, metallic (colour selection)	23.990 €
XA3001	Waterline and cove line, coloured gelcoat (colour selection - not with XA1002 or XA1003)	790 €
XA3002	Waterline and cove line, painted, non metallic (colour selection - only with XA1002 or XA1003)	890 €
XA3003	Waterline and cove line, painted, metallic (colour selection - only with XA1002 or XA1003)	1.090 €

KEEL

XB1001	L-keel, cast iron/lead, draft: 1.98 m	10.590 €
XB1002	T-keel, cast iron/lead, (competition) draft: 2.38 m	13.790 €
XB1003	L-keel, cast iron, draft: 2.16 m	4.490 €
XB9000	Keel and rudder - not mounted	990 €
XB9101	Rudder - Competition	1.590 €

LAYOUT & INTERIOR

XL1002	A2: Master cabin with double V-berth, hanging locker, shelves and separate head on stb	3.090 €
XL3002	C2: 2 aft cabins with double berth and storage, on port with entrance from head	1.990 €
XL7200	Double berth in saloon	1.290 €
XL7601	Worktop in galley - Black	790 €

WOOD (FURNITURE, FLOORBOARD)

XM1101	Furniture - Teak	5.490 €
XM1103	Furniture - Oak	5.490 €
XM1201	Floorboard - Noce Nero	890 €
XM1202	Floorboard - Classic Stripes	1.790 €
XM1203	Floorboard - Piave Oak	890 €
XM9000	Floorboard - Wood style flooring in all heads and showers	690 €

UPHOLSTERY

XN1100	Deluxe mattresses for all berths	2.290 €
XN2001	Upholstery - Arctic (colour selection)	890 €
XN2002	Upholstery - Pacific (colour selection)	1.390 €
XN2003	Upholstery - Biscay (colour selection)	2.090 €

XN2004	Upholstery - Adriatic Leather (colour selection)	3.990 €
XN2500	Cockpit cushions (colour selection)	2.290 €
XN2510	Head cushions in saloon	690 €

DECK & OUTSIDE EQUIPMENT

XC1300	Teak on side decks	12.990 €
XC1301	Flexiteek on side decks (colour selection)	13.390 €
XC2201	2 GRP steering wheels, Y-spoke (black or white)	1.790 €
XC3001	Fixed cockpit table, stainless steel with folding teak tops and retractable LED light	2.490 €
XC3004	Removable cockpit table, stainless steel with foldable teak tops	2.490 €
XC3030	Instrument pod on coach roof (not with XE2012)	890 €
XC4001	Gateway stanchion (not with XC4002)	990 €
XC4002	Railing, stainless steel wire, competition performance	890 €
XC5103	2 LEWMAR 45 Race halyard winches, port: manual - stb: electric with automatic fuse (only with XH1001)	3.290 €
XC5301	2 LEWMAR 50 Race manual mainsheet winches	1.490 €
XC5302	2 LEWMAR 45 Race electrical mainsheet winches with automatic fuse (only with XH1001)	6.390 €
XC6501	Gangway, carbon, foldable with bag, 220 cm	2.990 €
XC9021	Rub rail, stainless steel	1.890 €
XC9070	Halyard bags	590 €
XC9170	Composite bowsprit with integrated anchor fitting	2.890 €
XC9280	Jib barber hauler with low-friction ring	490 €

RIG & SAILS

XE1002	Mast (Competition), carbon with rod rigging and black alu boom	38.990 €
XE2001	Maindrop system with lazy jacks (colour selection)	1.290 €
XE2012	Sprayhood with stainless steel stake, 3 windows (1 openable) (colour selection)	2.740 €
XE3002	QUANTUM AC5 performance sails (Competition) - full battened, triradial, main and jib (only with XE1002)	2.490 €
XE3005	QUANTUM TP6 high-performance sails - full battened, UV-protected membrane, main and jib	8.890 €
XE3007	QUANTUM TP6 high-performance sails (Competition) - full battened, UV-protected membrane, main and jib (only with XE1002)	10.990 €
XE3206	QUANTUM Spinnaker (Competition) (colour selection - only with XE1002)	2.990 €
XE3300	QUANTUM Freeride sail - with CX endless furler and storage bag (only with XC9170)	6.290 €
XE3302	QUANTUM Freeride sail (Competition) - with CX endless furler and storage bag (only with XC9170 and XE1002)	7.390 €
XE4003	Spinnaker package incl. carbon pole, halyard, 2 sheets, 2 blocks and padeyes	4.890 €
XE9003	Gennaker/Freeride package incl. halyard, 2 sheets, 2 blocks and padeyes	1.390 €

NAVIGATION & INSTRUMENTS

XF2223	2 B&G Triton ² multifunction displays at companionway (only with XC3030)	1.390 €
XF2224	2 B&G H5000 multifunction displays at companionway (only with XC3030 and XW2011)	1.890 €
XF3000	B&G VHF V60 at chart table, incl. wireless remote handset H60 (only with XK5000)	1.190 €
XF4000	B&G Zeus ³ 7" chart plotter at chart table	2.490 €
XF4560	MyDehler Safety Cloud hardware with 30 days free trial subscription and an interior light, switchable by APP	1.490 €
XF4600	B&G AIS Class B transponder (only with chart plotter and XK5000)	1.590 €

XF4650	Thermal vision camera at mast (only with Navigation Package)	6.390 €
--------	--------------------------------------------------------------	---------

PROPULSION

XG1001	Engine (Diesel, approx. 39 hp) - saildrive, 2 blade folding propeller	2.990 €
XG1003	Engine (Diesel, approx. 39 hp) - saildrive, 3 blade folding propeller	3.490 €
XG3101	Bowthruster, 12 V, retractable, incl. battery	9.490 €

EQUIPMENT

XH1110	Deep charge protection for service batteries	1.390 €
XH1601	Country Version: US / JPN	1.490 €
XH2201	Inverter/charger, 12 V / 1600 W - 60 A, incl. larger AC panel (only with XH1001)	2.790 €
XH3001	Electric toilet with sea water flush	1.390 €
XH4011	Heating, hot air with up to 6 blowers	5.690 €
XH5409	Gas leak detector	990 €
XH6001	Grey water system for bathrooms and galley, tank: 58 l	1.990 €

RADIO & ENTERTAINMENT

XK5000	VHF preparation with antenna and splitter for FM and AIS	490 €
--------	----------------------------------------------------------	-------

ACCESSORIES

XV9120	Cockpit table cover (colour selection)	490 €
XV9130	Cover for steering wheels (colour selection)	590 €
XV9380	Shrink wrap foil (for storage purpose only / not for transport) (not with XA1002 or XA1003)	790 €

SHIPPING & TRANSPORT

XZ2001	Loading on truck	590 €
XZ2003	Oversea shipping pack (cradle)	3.290 €
XZ2020	Ready for pickup	690 €

All mentioned prices in €, basic prices ex yard and excl. VAT. All weights and measures are calculated numbers based on the construction data. Changes in construction and equipment reserved. Above mentioned prices are recommended for ex yard deliveries within 4 month after order confirmation. For later delivery time the company reserves right to apply latest price list. Company reserves additional 15 working days when painted hull or deck is ordered. All measurements/figures are approximate. Errors and omissions excepted. Specification and material can be changed without notice. Valid from 2023.01.01 for deliveries until 2023.12.31.