



SPECIFICATION & PRICELIST C390

PRINCIPAL DIMENSIONS according to ISO 8666

Length Overall (Lmax)	11.99 m	39' 4"
Length Overall (Lmax) - ext. platf.	12.50 m	41' 0"
Length of Hull (LH)	11.00 m	36' 1"
Beam (BH)	3.85 m	12' 8"
Draught (Tmax)	1.19 m	3' 11"
Air height	3.80 m	12' 6"
Fuel capacity	900 l	198 UK gal
Water capacity	350 l	77 UK gal
Displacement	10.52 t	10.35 UK t
CE Category - max. pers.	B - 10	C - 14

ENGINE STANDARD

2 x Volvo Penta D4 320 HP stern drive	27 knots*
---------------------------------------	-----------

ENGINE OPTION

2 x Volvo Penta D6 380 HP stern drive	34 knots*
---------------------------------------	-----------



*All performance figures are given in good faith and are intended as an indication. These figures cannot be guaranteed as top speed in particular is affected by the cleanliness of the hull, conditions of the propellers, weight carried and air/sea temperature. Performance is related also to the optional accessories selected. SEALINE reserves the right to change specifications in line with the company policy of improvement through research and development. Standard Propeller tested in Greifswald according to Volvo conditions. All measurements/figures approximate. Errors and omissions excepted. Specification and material can be changed without notice. Please check with your dealer for a full list of inclusions. **To be confirmed after seatrial. Valid from 2025.08.01

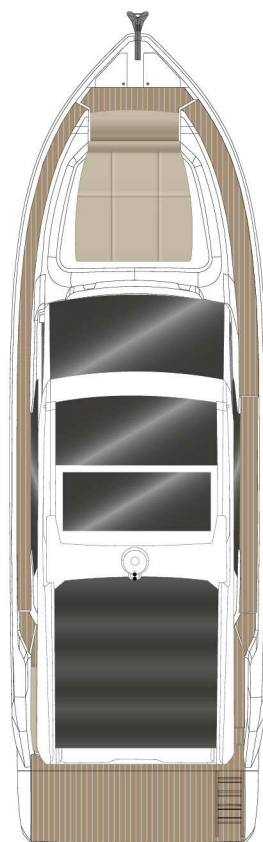

ROOF

D1



MAIN DECK

standard

D2



MAIN DECK

option

B1

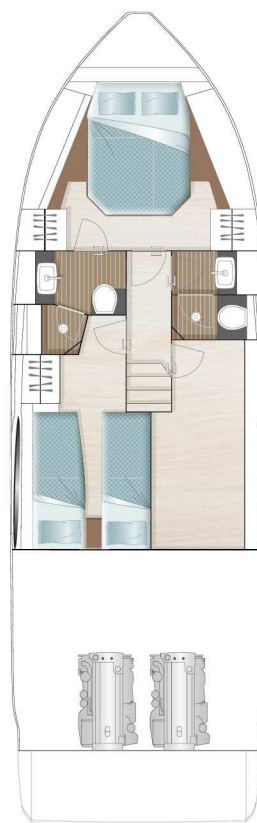

LOWER DECK

standard

A1

C1

B1

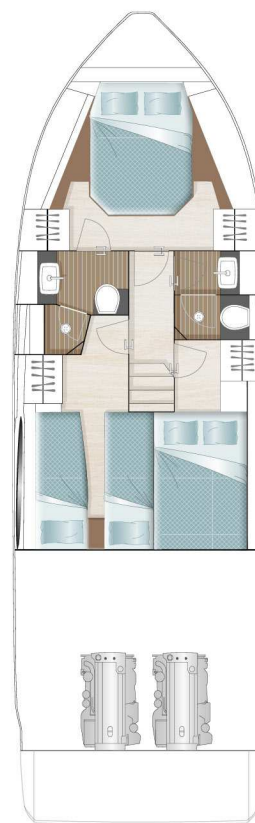

LOWER DECK

option

A1

C2

B2

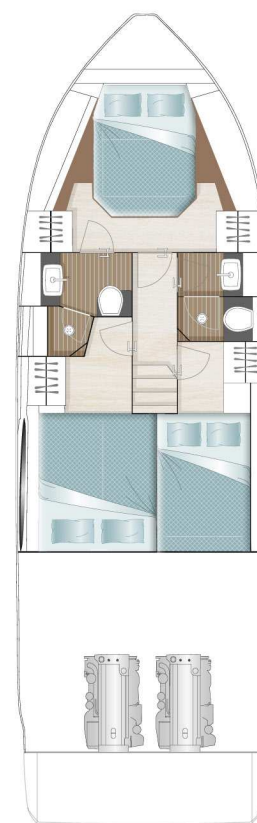

LOWER DECK

option

A1

C2

HULL

- GRP hull, ISO NPG gelcoat, colour: STAR WHITE, 1st layer Vinyl ester resin, sandwich construction, composite structural bulkheads
- Waterline, isophthalic gelcoat, colour: BLACK
- Aft pillar vinyl wrapped in GREY with SEALINE logo
- 1 hull window (master cabin starboard side)
- 4 hull windows with openable porthole (master cabin port side, VIP cabin, and toilettes)

DECK & COCKPIT

- GRP deck, molded antiskid surface, ISO NPG gelcoat, colour: STAR WHITE, 1st layer vinyl ester resin, sandwich construction, anchor locker, self draining, anchor arm stainless steel
- Fender strip, rubber, colour: BLACK
- SEALINE steering wheel and throttles
- Full windscreen with pantograph wipers and screen wash
- SEALINE convertible fabric roof system in cockpit, manual
- Panoramic side full glass windows, skylight in saloon and 2 openable hatches in saloon
- Bifold door between cockpit and galley and tilting window to enlarge galley into cockpit
- Bathing platform in fiberglass, bathing ladder with handrail and bathing shower with hot and cold water and opening stainless steel gate
- Manual engine hatch
- Stainless steel pulpit, 4 stainless steel mooring cleats, stainless steel handrails
- Seating "L"-shaped bench with fixed backrest with storage underneath and teak bar
- Bench at bow, GRP surface

PROPULSION

- Engine room, sound insulated, fans with fire extinguisher system, automatic and manual, Batteries-Engines: 2 x 90 Ah / 12 V, Battery charger (only for engine batteries)
- 2 Volvo Penta D4-320 (320 hp) - DUOPROP STERN DRIVE with propeller H4, 2 Volvo

engine instrumentation 2.5" displays

- Fuel tank, capacity: 900 litres
- Fuel Filter

ELECTRICAL EQUIPMENT

- 12 V and 230 V electric system with 230 V shore power connection and switches, sockets in saloon (1), master cabin (2), VIP cabin (1), galley (2), toilettes (2), engine room (1), 12V on dashboard (1) and storage room (1)
- Battery set, capacity: 1x 260 Ah, Service battery charger
- Country Version: EU / AUS
- Manual toilets
- Light in cabins, saloon and galley with dimmer. Dimmable indirect lights and reading lights in cabins. Lights in toilettes, cockpit and engine room
- Front screen demister
- Holding tank (170 l)
- Water tank (350 l) with gauge, fresh water pump and boiler (40 l)
- Bilge pumps: automatic electric (2) and manual emergency bilge pump in cockpit (1)

NAVIGATION & INSTRUMENTS

- Standard dashboard with engine room fire extinguisher system
- Compass
- Navigation lights

LAYOUT & INTERIOR

- A1: Master cabin with double berth, 2 wardrobes and sideboards with stowage and two bedside tables. 1 drawer underneath the bed. 3 Skylights, one openable, direct access to separated head. Fully equipped head with separated shower stall with skylight, handheld shower, and comfort seat with wood cover.
- B1: VIP cabin with twin berth, wardrobe and sideboard with stowage on port side, skylight
- C1: Storage room and fully equipped day head with separated shower stall, handheld shower

and seat on starboard side

- D1: Saloon with "L" shaped sofa, pilot seat, galley with stowage, fridge with freezer compartement, gas stove - 2 burners, 1 gas oven and sink with draining basin
- Saloon table with fixed leg
- Counter tops in galley, in BISTRO material (according to colour card)

UPHOLSTERY & WOOD

- Upholstery scheme CASABLANCA, colour: PEARL WHITE (according to colour card)
- Exterior seating material in SARDINIA, colour GULL WING (according to colour card)
- Upholstery helmsman seat: CASABLANCA, colour: PEARL WHITE (according to colour card), Bed frames and bedheads in all cabins in soft material, colour: SILVERTEX ANTHRACITE
- Standard mattresses in all cabins
- Interior furniture in high quality marine plywood: MADISON WOOD (according to colour card)
- Floorboard in saloon, galley and cabins - AUSTRALIAN ACACIA (according to colour card)

TRANSPORT

- Identified locations for hand held fire extinguishers - (hand held fire extinguishers are not supplied), SEALINE Owner's Manual in SEALINE document bag

AS PER STANDARD SPECIFICATION

excl. VAT
461.000 €

PROPULSION

XC2005	2 Volvo Penta D6-380 (380 hp) - DUOPROP STERN DRIVE with propeller H5	30.250 €
XC2006	2 Volvo Penta D6-380 (380 hp) - DUOPROP STERN DRIVE with propeller H4	30.600 €
XC5001	Joystick for stern drives (only with XC2005 or XC2006)	16.550 €
XC6001	Bowthruster, 8 hp	6.250 €

PACKAGES

XW2000 Navigation Package 17.750 €

XN1001	Raymarine i70s multifunctional display with transducer (speed, depth, temp) at helm position
XN1501	Raymarine AXIOM2 PRO 12 S chart plotter at helm position with GPS antenna
XN1602	Enlarged dashboard
XN2101	Raymarine Ray90 VHF
XN3001	Raymarine Autopilot with control unit at helm position
XN6001	VHF antenna with splitter for FM and AIS

XW2010 Upgrade to Navigation Package XW2000 - instead of AXIOM2 PRO 12 S 3.150 €

XN1502	Raymarine AXIOM XL 16 chart plotter at helm position with GPS antenna
--------	---

XW3000 Cruising Package 14.150 €

XB4005	Anchor 16 kg, galvanized with 60 m chain
XB4010	Reversible electric windlass with automatic fuse and remote control at helm position
XB4122	4 additional cleats, 2 at each side
XC5101	Trim Tabs with automatic control
XC7001	Steering wheel, adjustable tilt
XV1000	Cockpit canopies (according to colour card)
XV5001	8 fenders
XV9902	4 mooring lines

XW5000 Comfort Package 22.600 €

XA5105	Openable glass porthole in master cabin on starboard side
XB1039	Synthetic teak on platform, steps to cockpit and in cockpit (according to colour card)
XB3111	Saloon opening roof, electric drive with blinds
XD3202	Electrical toilet - on starboard side
XD3204	Electrical toilet - on port side
XU1020	Sunbed cushions for foredeck with liftable backrest (according to colour card)
XV7500	Mosquito nets in fwd hatch
XV9060	Blinds for hull windows
XV9061	Blinds for hatches

XW5001	Upgrade to Comfort Package XW5000 - instead of synthetic teak	2.400 €
---------------	--	----------------

XB1038	Real teak on platform, steps to cockpit and in cockpit
--------	--

XW5500	Lighting and Charging Package	3.150 €
---------------	--------------------------------------	----------------

XD2070	Wireless mobile charging (2 owner cabin, 1 saloon)
--------	--

XD4001	Courtesy light in the companionway to cabin
--------	---

XD4023	LED light on side decks
--------	-------------------------

XD4052	Indirect light in saloon, heads and galley
--------	--

XW6000	Dock & Drive Power Package (only with XC2005 or XC2006 and XW2000)	22.850 €
---------------	---	-----------------

XC5001	Joystick for stern drives (only with XC2005 or XC2006)
--------	--

XC5002	Volvo cruise control
--------	----------------------

XC5003	Volvo power trim assistant
--------	----------------------------

XC5010	Volvo 7" engine display
--------	-------------------------

XN5001	Volvo trip computer
--------	---------------------

XW6500	Smart Connection Package	5.000 €
---------------	---------------------------------	----------------

XE3110	WLAN router
--------	-------------

XN3820	Interior camera
--------	-----------------

XW7000	Entertainment Package - saloon and cockpit (only with XN6001 or XW2000)	2.950 €
---------------	--	----------------

XE2000	FUSION APOLLO MS-RA770 with AM/FM in saloon
--------	---

XE2101	2 high-end 2 way speakers in saloon
--------	-------------------------------------

XE2107	2 high-end 2 way speakers in cockpit
--------	--------------------------------------

XE2207	FUSION MS-ERX400 remote control in cockpit
--------	--

XW7001	Entertainment Package - master cabin (only with XE5111 and XN6001 or XW2000)	3.400 €
---------------	---	----------------

XE2005	FUSION APOLLO MS-RA770 with AM/FM in master cabin
--------	---

XE2106	2 high-end 2 way speakers in master cabin
--------	---

XE5005	TV flat screen in master cabin
--------	--------------------------------

XE5015	TV preparation in master cabin
--------	--------------------------------

XW7501	TV Package - saloon (only with XE5111)	2.700 €
---------------	---	----------------

XE5001	TV flat screen in saloon
--------	--------------------------

XE5010	TV preparation in saloon
--------	--------------------------

XE5051	TV bracket
--------	------------

OPTIONS

excl. VAT

HULL

XA5108	Electric openable window on port side in saloon	5.900 €
--------	---	---------

DECK & COCKPIT

XB1020	Real teak on side decks and bow	11.700 €
--------	---------------------------------	----------

XB1021	Synthetic teak on side decks and bow (according to colour card)	11.600 €
--------	---	----------

XB1505	Hull fender strip in white rubber with stainless steel insert	2.400 €
--------	---	---------

XB3101	SEALINE convertible fabric roof system in cockpit, electric	7.200 €
--------	---	---------

XB3212	Saloon door, starboard side	4.750 €
--------	-----------------------------	---------

XB3501	Enlarged bathing platform fixed, with real teak (only with XW5000 and XW5001 - not with std. engine)	9.050 €
--------	--	---------

XB3502	Enlarged High/Low movable bathing platform, with real teak (only with XW5000 and XW5001 - only with XC2005 or XC2006)	26.100 €
--------	---	----------

XB3503	Enlarged bathing platform fixed, with synthetic teak (only with XW5000 - not with std. engine) (according to colour card)	8.750 €
--------	---	---------

XB3504	Enlarged High/Low movable bathing platform, with synthetic teak (only with XW5000 - only with XC2005 or XC2006) (according to colour card)	25.800 €
XB3610	Electric openable engine hatch	1.200 €
XB4110	Anchor chain counter at helm position	1.050 €
XB4300	Freshwater dockside connection in transom	600 €
XB4310	Freshwater wash down	1.050 €
XB5011	Foldable copilot seat port side (only with XL7001)	1.850 €
XB5101	Convertible aft backrests lower and raise (electric) in cockpit (not with XD5040)	3.550 €
XB5500	Cockpit table foldable with fixed leg and cover (only with XB3610)	3.150 €
XB5501	Cockpit table foldable with high/low leg, sun cushion and cover (only with XB3610)	5.150 €
XB7500	Dinghy Chocks loose on board	950 €

ELECTRICAL EQUIPMENT

XD1002	Battery set, capacity: 2x 260 Ah with Battery charger	1.850 €
XD1110	Deep charge protection for service batteries	1.450 €
XD1601	Country Version: US / JPN	4.250 €
XD1602	Country Version: UK	1.100 €
XD2001	Inverter/charger with battery management (only with XD1002)	5.400 €
XD3001	Fischer Panda generator 10.000i, 8.0 kW (not with std. engine)	18.100 €
XD3101	2nd shore power 230 V or 110 V	1.950 €
XD5002	Electric cooktop, 2-rings (only with XD5150) and (only with XD3001 or XD3101 or XD6002)	1.250 €
XD5040	Gas grill, furniture with sink, light and worktop, at stern (only with XB3501, XB3502, XB3503 or XB3504) (not with XB5101)	6.250 €

XD5150	Microwave (not with standard gas oven - only with XD5002)	950 €
XD6002	Air conditioning incl. 2nd shore power (only with XD3001 - not with std. engine)	22.750 €
XD7001	Hot air heating in saloon, cabins and heads	7.250 €
XD8003	Grey-water tank with electric pump for overboard discharge or deck suction	3.500 €

ENTERTAINMENT

XE5111	DVB-T2 digital tv antenna	1.100 €
--------	---------------------------	---------

NAVIGATION & INSTRUMENTS

XN1602	Enlarged dashboard	3.600 €
XN2001	Raymarine Quantum Radar 2 (only with XN2004 and XW2000 or XW2010)	4.450 €
XN2004	Enlarged mast	550 €
XN3500	AIS (only with XW2000 or XW2010)	1.850 €
XN3560	MySEALINE Safety Cloud hardware with 30 days free trial subscription and an interior light, switchable by APP	1.350 €
XN3600	Raymarine fishfinder (only with XW2000 or XW2010)	1.900 €
XN3800	Camera aft facing (only with XW2000 or XW2010)	2.300 €
XN6001	VHF antenna with splitter for FM and AIS	800 €
XN9200	Spotlight with remote control (only with XN2004)	950 €

LAYOUT & INTERIOR

XL2002	B2: VIP cabin with double berth, wardrobe and sideboard with stowage on port side	1.200 €
XL3002	C2: Guest cabin with double berth, wardrobe and fully equipped day head with separated shower stall on starboard side, window with openable porthole (only with B1 layout or XL2002)	3.250 €

XL4002	D2: Additional slidable seat in saloon with drawer fridge underneath, galley with stowage, fridge with freezer compartement, gas stove - 2 burners, 1 gas oven and sink with draining basin	3.850 €
XL7001	Saloon table foldable with fixed leg	950 €
XL8001	Worktop in galley - SPRING WHITE (frames in marine mineral stone, top in HPL - according to colour card)	600 €

UPHOLSTERY & WOOD

XU1001	Upholstery - BALI (according to colour card)	1.800 €
XU1002	Upholstery - CAPETOWN (according to colour card)	2.000 €
XU1004	Upholstery - LONG ISLAND LEATHER (according to colour card)	4.700 €
XU1011	Exterior upholstery - SARDINIA (according to colour card)	1.050 €
XU1012	Exterior upholstery - MADEIRA (according to colour card)	850 €
XU1013	Exterior upholstery with decorative stitching - HITCH (according to colour card)	2.150 €
XU1031	Upholstery helmsman seat - BALI (according to colour card)	850 €
XU1032	Upholstery helmsman seat - CAPETOWN (according to colour card)	1.000 €
XU1034	Upholstery helmsman seat - LONG ISLAND LEATHER (according to colour card)	1.350 €
XU1510	Carpet in cabins (according to colour card)	2.600 €
XU5001	Furniture - ONTARIO OAK (according to colour card)	5.350 €
XU5002	Furniture - SHERWOOD CHESTNUT (according to colour card)	5.900 €
XU5003	Furniture - ATLANTA WALNUT (according to colour card)	4.850 €
XU5100	Furniture - HIGH GLOSS FINISH (only for XU5002 or XU5003)	10.800 €
XU6011	Floorboard in saloon, galley and cabins - VENECIAN BLACK WALNUT (according to colour card)	1.200 €
XU6013	Floorboard in saloon, galley and cabins - CALIFORNIAN OAK (according to colour card)	1.350 €

ACCESSORIES

XV1007	Outside screen cover, front and side triangle screen (according to colour card)	2.400 €
XV1008	Cover for bow cushions (according to colour card)	1.200 €
XV9100	Plisse on sliding door and tilting window	1.200 €
XV9104	Plisse for saloon	4.750 €

TRANSPORT

XZ2001	Loading on truck with disassembled deck parts and antennas	950 €
XZ2010	Oversea shipping cradle	3.500 €
XZ2020	Ready for pickup	650 €

All mentioned prices in €, basic prices ex yard and excl. VAT. All weights and measures are calculated numbers based on the construction data. Changes in construction and equipment reserved. Above mentioned prices are recommended for ex yard deliveries within 4 month after order confirmation. For later delivery time the company reserves right to apply latest price list. Company reserves additional 15 working days when painted hull or deck is ordered. All measurements/figures are approximate. Errors and omissions excepted. Specification and material can be changed without notice. Valid from 2025.08.01